

matrix
M1 Pro



Smart Coffee Scale
Instruction Manual



General Function

- press to start/pause timing
press and hold to reset timing
*This Button is Valid in MD2 mode only
- press the to reset the present mode
press the twice to switch brewing modes
- Press to tare
Press and hold to Power On/Off
- Press to change units
Press and hold to turn on/off the buzzer

MD1-Coffee Brew Ratio Mode

Truly intelligent mode on M1 Pro allows you to know the volume of water poured and how much coffee you brewed by a single scale through following steps:

- Put pitcher on the scale, and the weight resets to zero automatically.
⊖ indicates an auto-zero of weight
 - Put on the rest of equipment (such as filter, filter paper), and do anything you want to do before pouring in coffee grounds, and then press to tare the weight. **⊖**
 - Add the coffee grounds, and press to start the process, then you will see the weight of coffee grounds is shown in red color at the bottom right, as well as the coffee to water ratio is shown at the bottom left.
 - Within pouring of water, the water volume is shown at the upper right, and the coffee to water ratio increases accordingly.
 - After finishing pouring of water, you can lift up the filter in order to see the volume of coffee brewed which is shown at the bottom right as well as the coffee brew ratio at the bottom left.
 - If you remove the pitcher from the scale, the process is completed and the final data (volume of water you poured & volume of coffee brewed & coffee brew ratio) will be displayed.
- ** If you need to stop or continue timing, please press the manually.

MD2-Universal Mode

(Applicable to various pulse pouring methods)
In the mode, there is no operation process requirement like MD1, but you can have fun with different pouring methods, such as pulse pouring, single pouring, or 4/6 method through the designed functions: auto-tare, manual-tare, accumulation of weight, and manual timing.

At the bottom right, it shows the increased weight each time, and automatically tare-to zero after 3 second stabilization.
At the upper right, it shows the weight accumulation for all increased weight. You can also tare the amount to zero manually by pressing the **⊖**.
At the upper left, it shows timing, you can press the to start and pause timing as you wish.

- click to start/pause timing
press and hold to reset timing
- click to tare

MD3-Espresso Mode

It is designed specially for Italian-style coffee machine, which enables barista to do with facility during ESPRESSO brewing.

Place the coffee scale onto the coffee machine, put the ESPRESSO cup on, it gets auto-zero once it senses the weight is stable

Timing mode automatically starts when the scale senses a change in weight, and stops with no changes in weight.



MD4-Coffee to Water Ratio Mode

The coffee to water ratio will be shown under this mode through the following steps:

- Place the equipment on the scale, (including pitcher & filter & filter paper) and the weight resets to zero automatically.
⊖ indicates an auto-zero of weight
- Add the coffee grounds, and press manually to tare the weight, then it shows 1 at the ratio area. Now, the process is ready to go!
- Within pouring of water, the timing starts, and the water volume is shown at the upper right as well as the coffee to water ratio water increases accordingly.
- While pouring of water is done, remove all equipment, then the timing stops, and the final data (volume of water you poured & weight of coffee grounds & coffee to water ratio) will be displayed.

Area Function

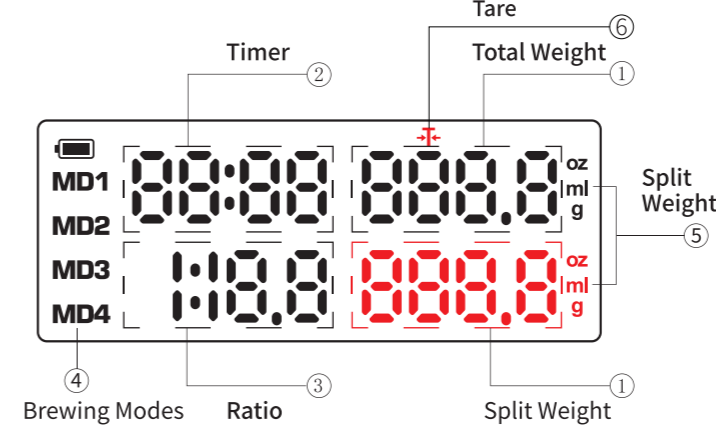

- 1-Weight Area capacity of 2000g
 - 2-Timing Area counting within 99'59"
 - 3-Ratio Area display of coffee grounds / water coffee grounds / brewed coffee
 - 4-Modes Area MD1/MD2/MD3/MD4
 - 5-Units Area oz / ml / g
 - 6-Tare
- * Battery icon Blinks when being recharged
always bright when fully recharged
* Battery icon flashes when low voltage, the scale turns off after LO appears, please recharge in time before using
* The scale will automatically shut down if it remains inactive for three consecutive minutes.

Scale Components (picture for reference only)

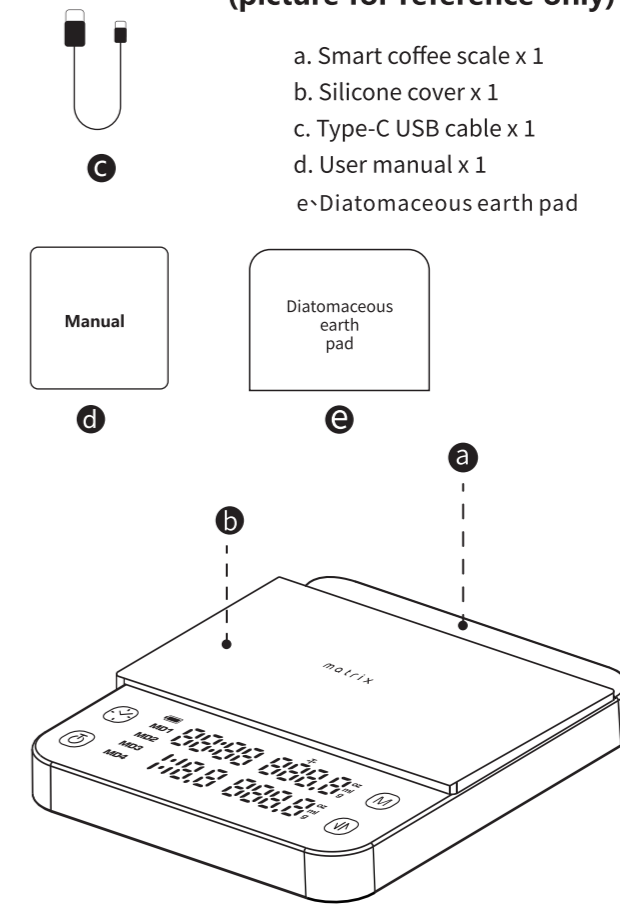

Warning

- The scale is not waterproof. Do not wash it and do keep the charging port dry.
- The weighing capacity is 2000g. Do not weigh with objects over the range.
- To maintain the battery lifespan, use a charging block with an output of 5 volts and 1 amp. Do not use the scale when plugged in.
- The scale must be used on a flat level
- The scale carries precise components. Stay away from any vigorous collision.

For any damage or inaccuracy caused by the ignorance of the above notices, we are not responsible.

* The product program and cosmetic design will be updated with the technology development. Please refer to the actual product.



matrix
M1 Pro

小智義式手沖雙顯咖啡電子秤



使用說明書



按鍵功能介紹

- 計時鍵
短按 開始/暫停計時
長按 時間歸零
MD2 模式下適用
- 模式鍵
短按 當前模式重置
連按 循環切換使用模式
- 電源 / 歸零鍵
短按 重量歸零
長按 開/關機
- 單位鍵
短按 轉換單位
長按 開/關聲音

使用問題 售後客服
掃碼登錄享保固



觀看使用操作影片

MD1-粉液比例模式

首創使用單秤就可以同時計算總注水量與最終萃取咖啡液重的智能模式
按照步驟操作，輕鬆得知咖啡粉與下壺咖啡萃取液之間的比例
進而幫助均勻萃取。同時掌握更多數據，實現沖煮樂趣

- 首先單獨放上咖啡下壺(或任何盛接咖啡液之容器) 穩定後設備重量自動歸零
⊖ 符號表示設備重量自動歸零
- 再放上其餘設備並完成所有準備動作後 短按 手動歸零所有沖煮設備 **⊖**
- 加入咖啡粉，重量穩定顯示在下方螢幕後 手動短按 ，準備進入注水沖煮流程
- 當粉水比例顯示區域出現時，此時可以開始注水 偵測到重量變化自動開始計重，同時開始計時 左下顯示區會即時顯示粉水比例
- 注水完成所需粉水比例後，當咖啡液還未完全滴落至下壺前，可單獨拿起濾杯控制最後滴漏變化，此時下方螢幕即時轉換顯示出下壺咖啡萃取液之正確重量及同步顯示粉液比(粉液比 = 咖啡粉重 : 萃取出咖啡液重)
- ** 最後移開下壺，可鎖定所有數據，並完成此次沖煮流程
** 需要停止計時，需手動按下停止計時鍵

MD2-自訂通用模式

(適用各種分段注水沖煮手法)

通用模式下，您可以自由透過手動歸零、計時鍵 輕鬆實現分段注水沖煮咖啡的計算需求
例如一段式、三段式、四六法等分段沖煮手法
每段注水時，分段水重會顯示在下方螢幕，穩定後自動歸零 上方則持續自動累加總注水量 幫助您掌握每段注水量的數值與時間

- 短按 計時開始/暫停
- 長按 時間歸零
- 短按 重量歸零

MD3-義式機專用模式

此模式專為義式咖啡機設計 將咖啡秤平放在咖啡機上，放下ESPRESSO杯 穩定後容器重量自動歸零 第一滴咖啡滴入杯中時開始計重，並自動計時 咖啡液停止時、計時自動停止



MD4-粉水比例模式

按照步驟依序操作智能粉水比例模式 自動為你換算粉水比例，不用費心計算 自動開始計時、秤重、結束 讓咖啡師在沖煮過程中更加精準且游刃有餘

- 首先放上所有準備完成的設備 *下壺、濾杯、濾紙(已完成浸潤) 穩定後設備重量自動歸零
⊖ 符號表示設備重量自動歸零
- 加入咖啡粉重量穩定顯示在螢幕後 手動短按 出現粉水比例顯示後 此時準備進入注水沖煮流程
- 開始注水，此時右上螢幕顯示注水量 偵測到重量後開始自動計時，粉水比例自動計算 當注水至所需的粉水比例後完成沖煮流程
- 完成所有沖煮流程後，移開電子秤上所有設備 時間會自動停止、螢幕鎖定並顯示當次沖煮資訊

區域功能

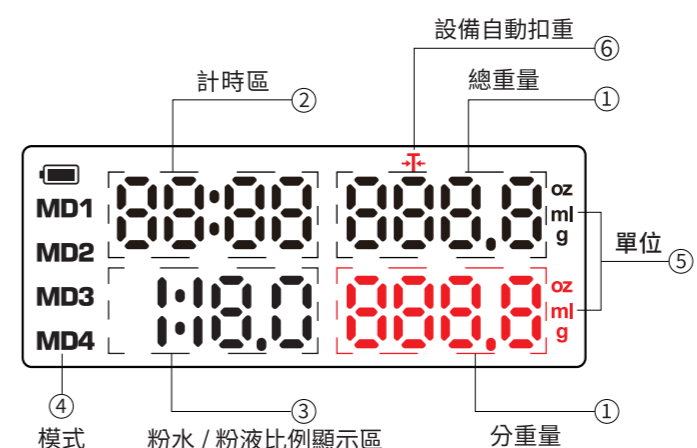

- 1-秤重區域 最大秤重為2000g
 - 2-計時區域 計時範圍99分59秒
 - 3-比例區域 粉水 / 粉液比例顯示區
 - 4-模式區域 MD1/MD2/MD3/MD4
 - 5-單位區域 oz / ml / g
 - 6-容器重量自動歸零
- * 充電顯示 充電時 螢幕電池燈號呈現閃爍狀態
充滿時 螢幕電池燈號呈現恆亮狀態
* 當電池符號閃爍時表示電壓低，當顯示LO時電子秤會關機 請即時充電後使用

* 機器 3 分鐘未動作自動關機省電功能(出廠值設定)

⊖ 符號表示設備重量自動歸零

產品配件

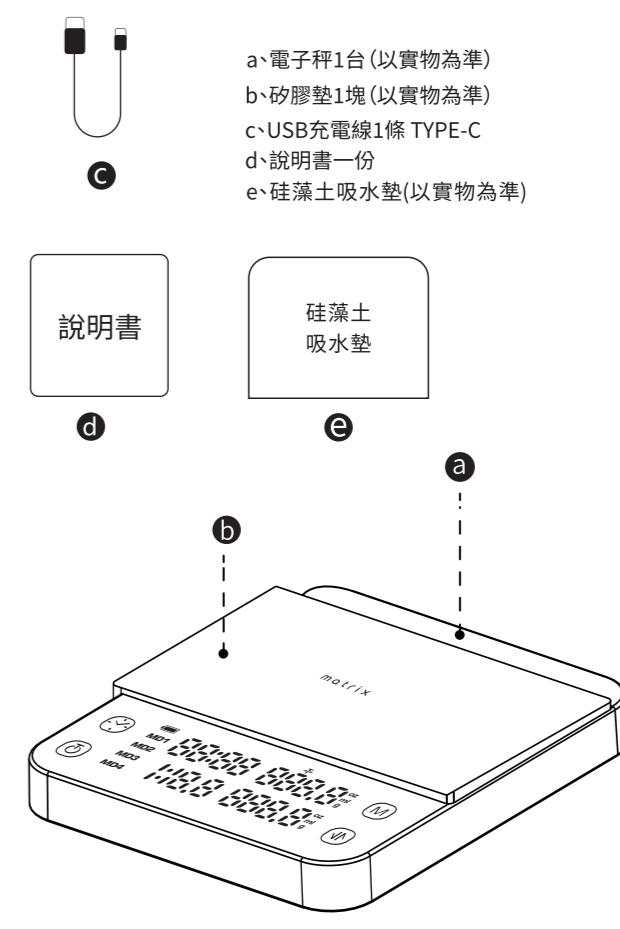

- a-電子秤1台(以實物為準)
- b-矽膠墊1塊(以實物為準)
- c-USB充電線1條 TYPE-C
- d-說明書一份
- e-矽藻土吸水墊(以實物為準)

名稱: Matrix M1 Pro 小智義式手沖 LED 觸控雙顯咖啡電子秤-TYPE-C 充電 (粉液比 / 分段注水 / 義式自動計時 / 濾渣土吸水墊)
產地: 中國 | 電壓: 5V-2A | Type-C 充電 | 內含 1000mAh 鋰電池 (請使用 5V=1A-2A 之間規格,切勿使用快速充電頭)
型號: M1 Pro (MXSM1PBK00)
工作模式: 粉液比 | 自訂通用 | 義式 | 粉水比 | 四種專用模式
淨重: 300g | 產品尺寸規格: 130*150*23.5 mm
含盒重: 500g | 外盒尺寸: 180*160*55 mm
秤重範圍: Max-2kg Min-0.5g *精度: 0.1g *差異: 1000g ±1g; 2000g ±1.5g
材質: ABS-矽膠 | 單位轉換 (g/ml/oz) | 製造日期: 詳見機身
內容物: 電子秤、矽膠墊、矽藻土吸水墊、充電線 (Type-C)、保固說明書
委製商 & 進口商: 漢德威自動化科技股份有限公司
地址: 高雄市大寮區上發一路 23 號

Email: cs@matrix.com.tw
官方客服 LINE@ID: @matrixlife

產品規格

適用範圍: 料理、烘焙、飲品、配方、咖啡

** 本產品電子秤非供交易使用
** 長期不使用時請固定時間充電，保持產品電力

- 電子秤不防水，請勿水洗及保持通電口乾燥
- 電子秤最大秤量為2000g，請勿秤量過重物體導致損壞
- 為保持電池壽命，請勿使用快充充電器，且充電中不能使用
- 使用時確保四個腳墊可以同時平穩接觸放置面
- 電子秤零件精密，請勿大力碰撞

注意事項:

- 本產品提供 6 個月的免費有限保固服務。
- 出現自然製造之瑕疵時(非人為因素)，本公司提供該產品免費保固維修服務。 經檢查後人為因素下造成的損壞，皆不適用商品免費保固維修服務，不論是否在保固期間內，如需維修，請提供以下的物品，以利後續作業
- 商品含完整包裝 B. 產品保證卡或購買證明 C. 完整配件及贈品
- 充電時請勿使用快速充電頭，以免影響充電電池性能。 電量實際使用因個人使用方法及使用時間有所差異。
- 矽膠隔熱墊/ 矽藻土墊屬使用性耗材不予保固，如購污請使用濕布擦拭清潔。

使用問題 售後客服
掃碼登錄享保固



觀看使用操作影片